

038

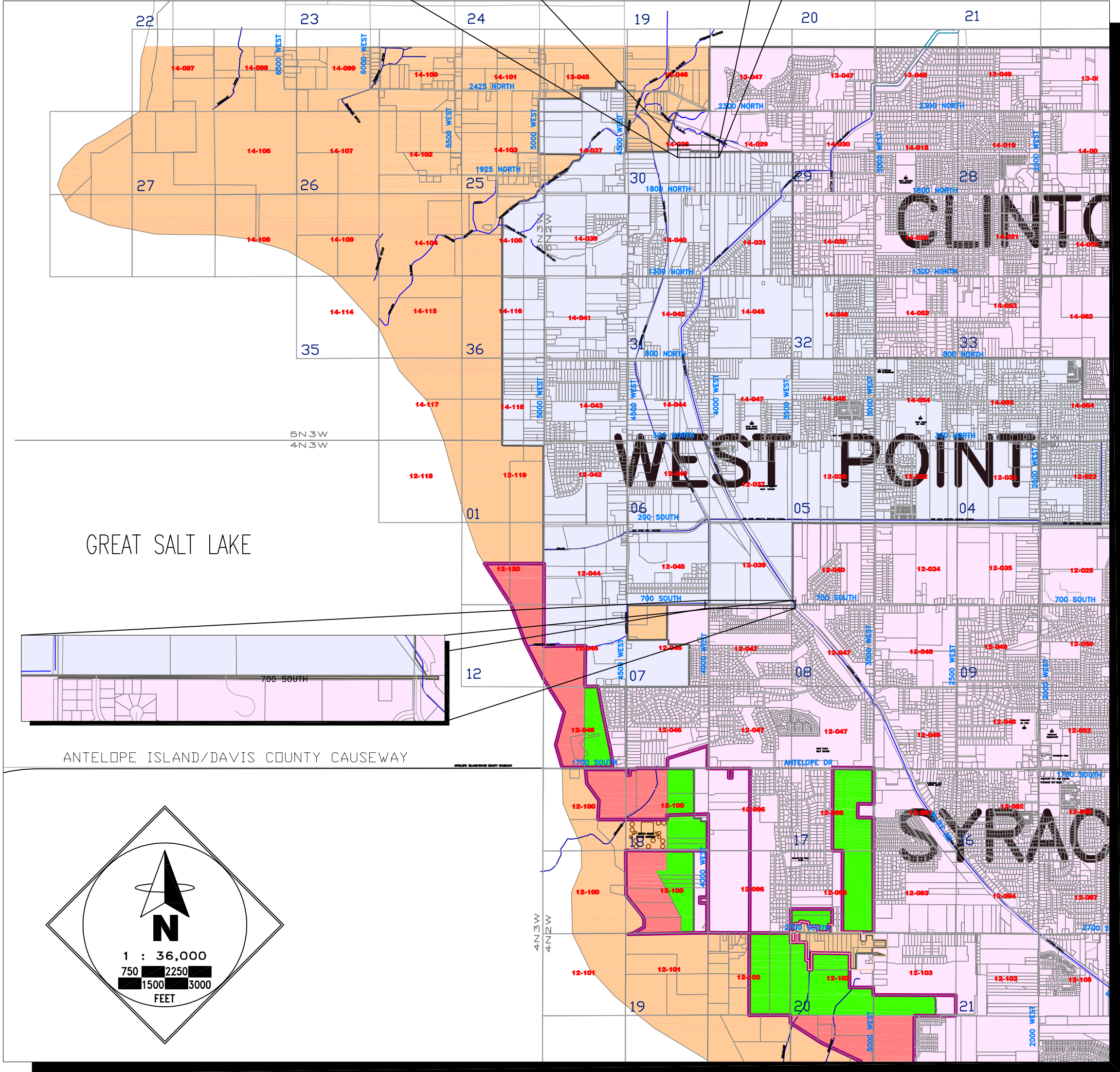

MATCH TO ABOVE LEFT

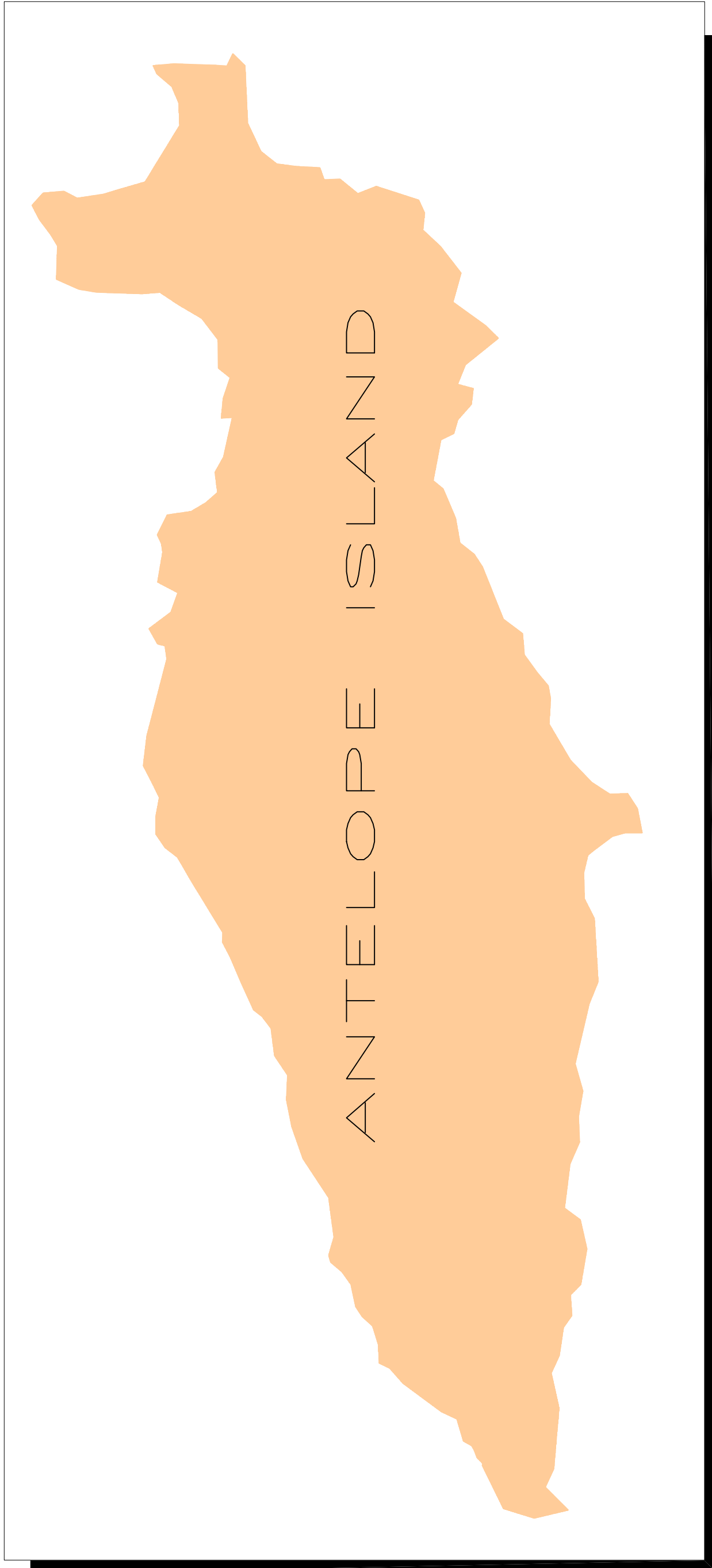

LEGEND	
	A-E
	A-1
	A-5
	A-10
	C-1
	C-2
	F-1
	M-1
	N-R
	R-1
	R-2
	R-3
	AGRICULTURAL PROTECTION AREA
	MUTTON HOLLOW TOWNSHIP PLANNING
	FAULT LINE SENSITIVE AREA

ANTELOPE ISLAND SCALE 1:72,000 1" = 6000'

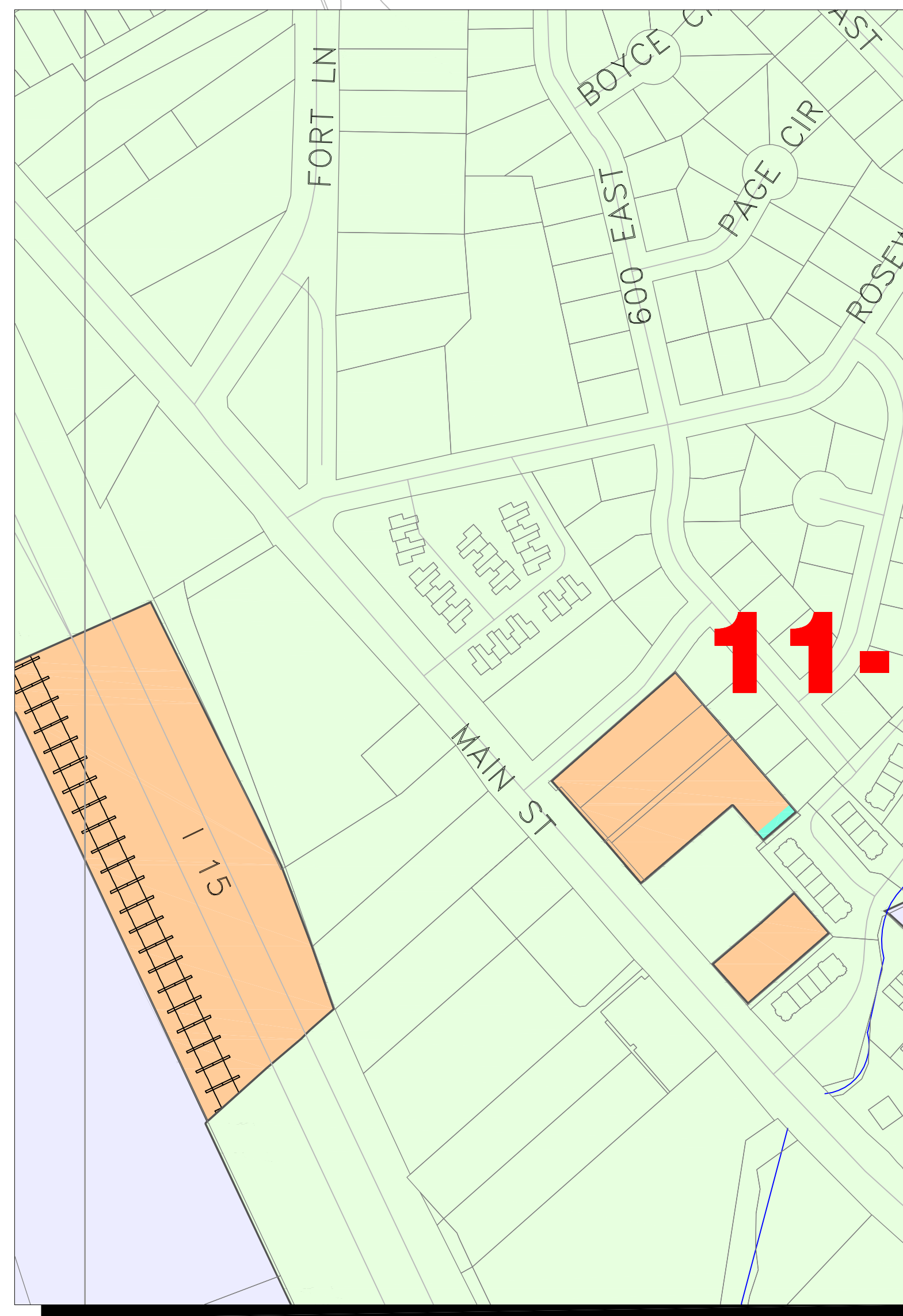

SOUTH MAIN ST. LAYTON AREA ZONING SCALE 1:2,400 1" = 200'

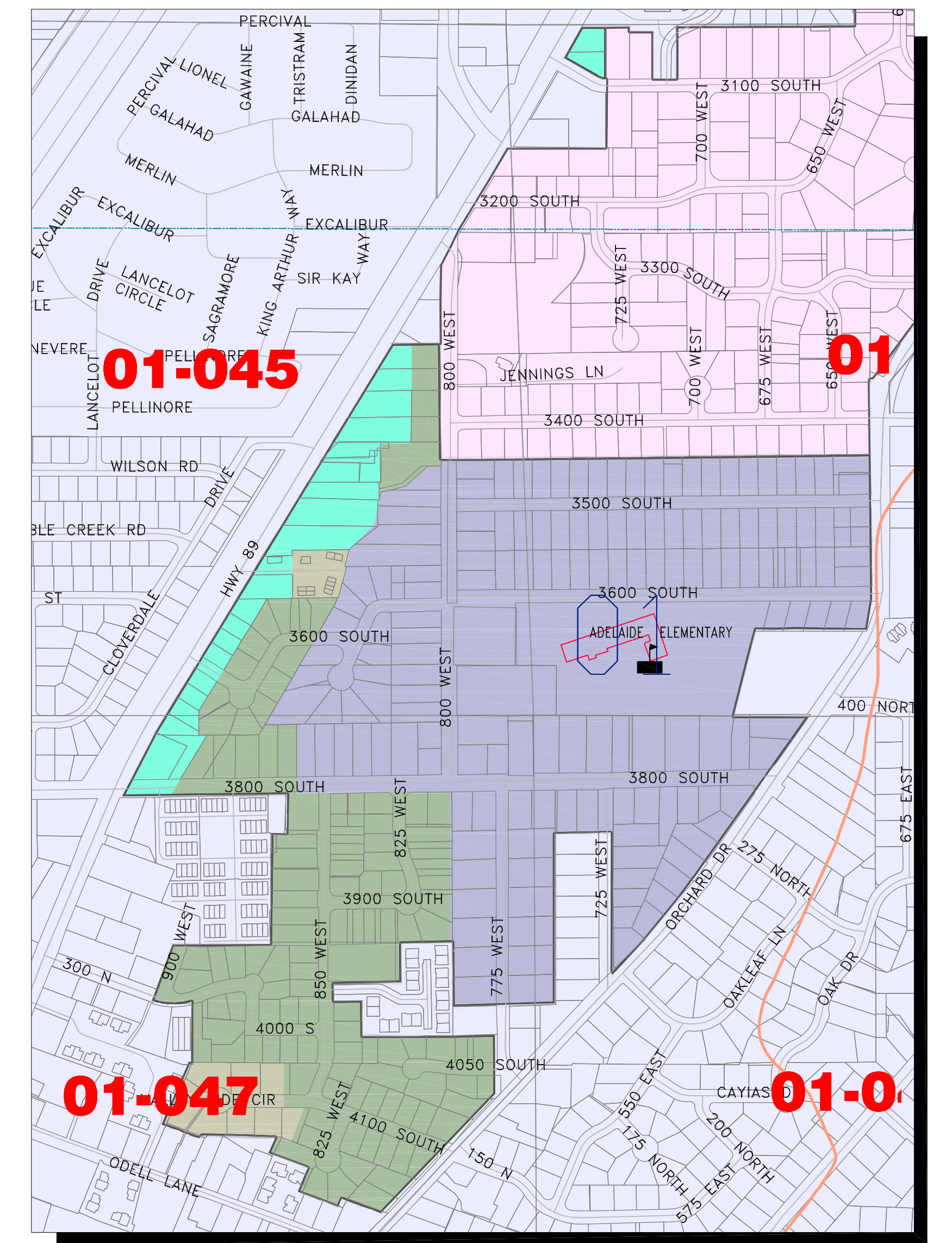

VAL VERDA AREA ZONING SCALE 1:4,800 1" = 400'

OFFICIAL ZONING MAP OF DAVIS COUNTY, UTAH

ATTEST OF PUBLIC HEARING HELD ON THE 17TH DAY OF DECEMBER, 1984
 SIGNED MICHAEL S. ALLPHIN, DAVIS COUNTY CLERK.
 APPROVED THIS 7TH DAY OF JANUARY, 1985. SIGNED GLEN E. SAUNDERS,
 DAVIS COUNTY COMMISSION CHAIRMAN.

UPDATED JUNE, 1996 TO CURRENT CITIES MUNICIPAL BOUNDARY LINES.

MUTTON HOLLOW TOWNSHIP NUMBER 1 ADDED OCTOBER, 1996.

MUTTON HOLLOW TOWNSHIP PLANNING DISTRICT ADDED MAY, 1997.

ORDINANCE NO. 6-2019, A-10 ZONING MAP AMENDMENT ADDED AUGUST, 2019.

UPDATED NOVEMBER 27, 2019 TO CURRENT CITY AND ZONING BOUNDARY LINES.